

Geek Robot Shuttle System

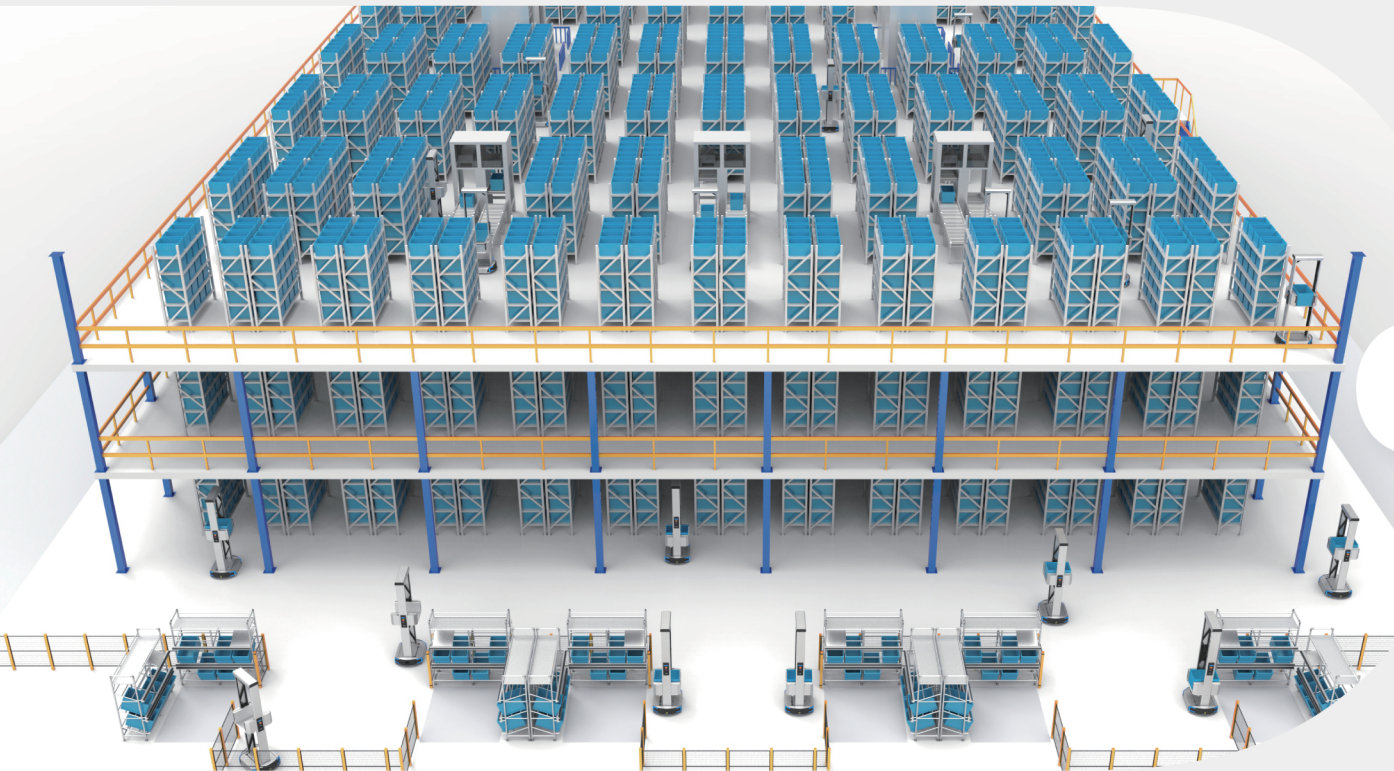

Geek+

Definition

Geek Robot Shuttle System combines the bin-carrying C200 series robot with normal mezzanine rack to realize “goods to person” picking as a cost-effective, high-storage-capacity and high-flexibility solution.

Features

Bin-Carrying for picking

- The robot carries standard bin to workstation for picking
- Intelligent scheduling, accurate navigation and automatic charging
- Suitable for multi-SKU storage and picking application
- Easy pick from the bin at the workstation compared to picking from shelves

Highly flexible and easy maintenance

- The robots operate on normal mezzanine racks, fits with existing warehouse
- Easy to adapt to change of work load by adding and removing robots
- Equipment easily accessible for maintenance

Cost effective

- Total cost could be about half of normal shuttle system
- Picking efficiency equivalent to shuttle system
- Storage capacity is equal to shuttle system

Values

Improved productivity with lower labor cost

Increased accuracy

Fast deployment and rapid ROI



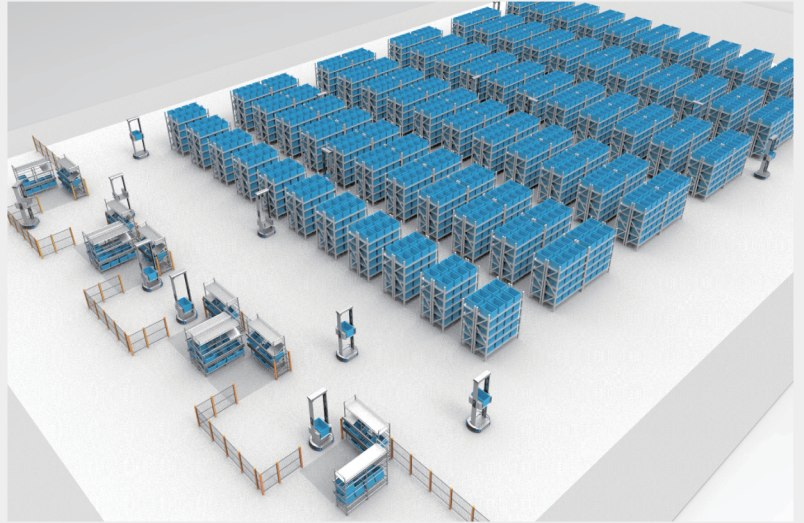

Application

Single-Layer Robot Shuttle System

- Robots operate on single layer rack
- Easy to deploy and expand
- Higher picking efficiency

Multi-layer Robot Shuttle System

- Robots operate on multi-layer mezzanine rack
- Increased storage capacity
- Single/multiple layer picking optional according to work load

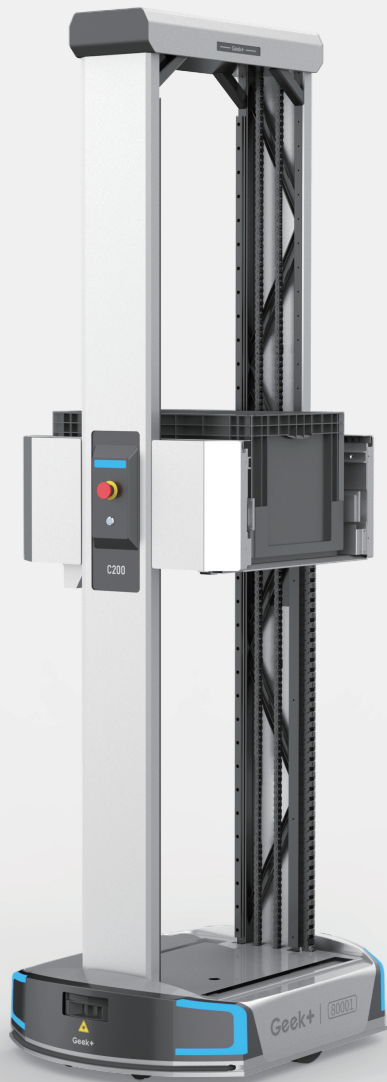

C200 Series Robot Parameter

Weight	270kg
Payload	40 kg
Capacity	1 bin
Bin size	600x400x350 mm
Height	2500 mm
Footprint	920x690 mm
Drive mode	Two-wheel differential drive
Speed	2 m/s
Charging mode	Automatic charging, user-defined method supported
Battery	LI, DC50.4V, 38.5ah
Navigation	2D bar code visual
Location accuracy	<10 mm
Obstacle avoidance	Infrared
Communication	WIFI/IEEE802.11 b/g